

**touch-plate®**  
LED LIGHTING & CONTROLS  
**Silver Series Wall Pack**  
**80w & 120w**



**DESCRIPTION:**

Touch-Plate's Wall Pack Lights were designed to offer better security, more lumens, and higher cost savings. Our Wall Pack Lights can offer energy savings of 70% or greater over traditional metal halide or high pressure sodium lighting. Our LEDs are optimal for new construction and retrofit installation.

**PRODUCT FEATURES:**

- Heavy-duty aluminum housing
- No flickering or humming
- Eco-friendly, no mercury
- Lifetime of 50,000 hrs or greater
- DLC Listed
  - o ML-WPB-80w
  - o ML-WPB-120w
- 5 Year Limited Warranty

**SPECIFICATIONS:**

- Wattage: 80w, and 120w
- Lumens: 9,600, and 14,400 (approx > 120lm/w)
- Equivalence: 150w and 200w HID/HPS/MH
- CRI: >80Ra
- IP Rating: IP65
- LED Chips: SMD 3030
- PF: >0.90

**PHYSICAL PARAMETERS:**

- Dimensions
  - o Length: 14.21"
  - o Height: 9.25"
  - o Depth: 7.7"
- Weight
  - o 12.13 lbs

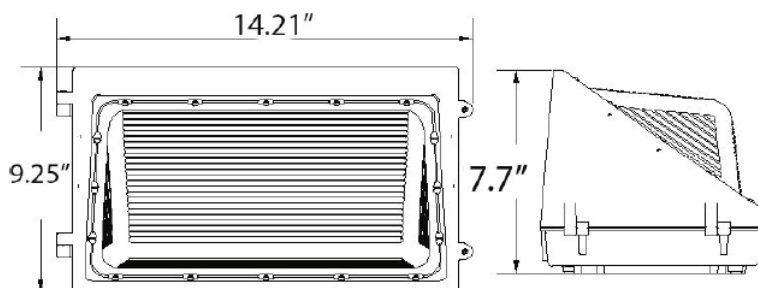





# Silver Series Wall Pack

## ORDERING GUIDE

LED Type XXX -	Lumens - Wattage XXX - XXX	CCT XX -	Voltage X	
<ul style="list-style-type: none"> <li><b>WPK</b> Wall Pack</li> </ul>	<ul style="list-style-type: none"> <li><b>096-080</b> 9,600lm-80w</li> <li><b>144-120</b> 14,400lm-120w</li> </ul>	<ul style="list-style-type: none"> <li><b>30</b> 3000k</li> <li><b>40</b> 4000k</li> <li><b>50</b> 5000k</li> <li><b>57</b> 5700k</li> </ul>	<ul style="list-style-type: none"> <li><b>U</b> 120-277v</li> </ul>	

## ACCESSORIES

(specified at time of order)

- PhotoUW^5a` fda ^

## PHOTOMETRIC

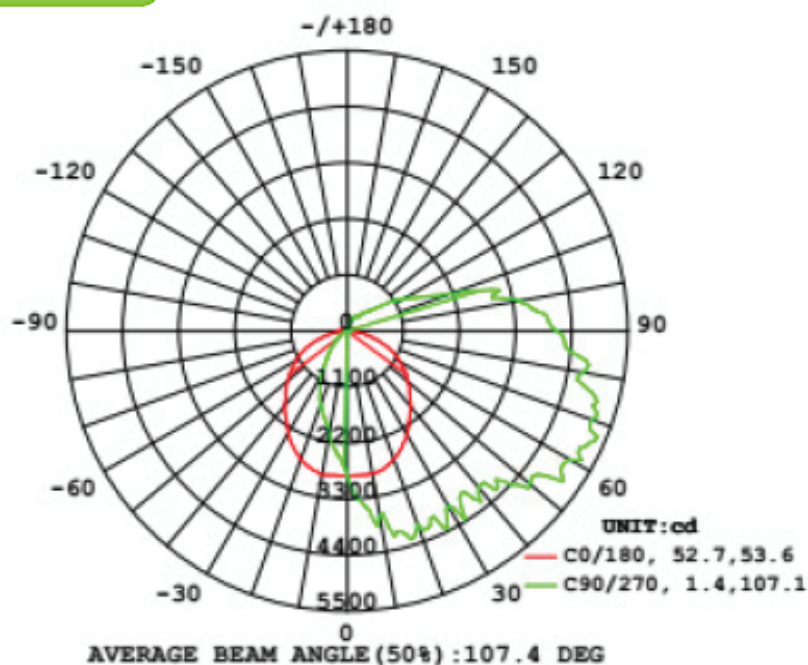

# Silver Series Wall Pack

## INSTALLATION INFORMATION (WIRING)

This product must be installed in accordance with National Electrical Code(NEC) and/or applicable local codes, by a qualified electrician.

### **DANGER - RISK OF SHOCK - DISCONNECT POWER BEFORE INSTALLATION**

Wall Packs can be ordered with a specified twist lock plug or without a plug.

Plug in the Wall Pack or make the necessary 'HOT' (Black or Brown), 'Neutral' (White or Blue), and 'Ground' (Green) connections in an approved junction box.

## INSTALLATION INFORMATION

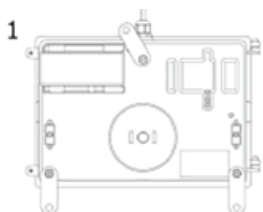

1 Rotate the 3 mountin brackets to the proper angle.

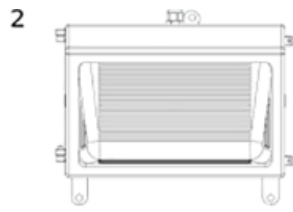

2 Hold the fixture to the wall making 3 marks according to the mounting brackets and drill holes for them.

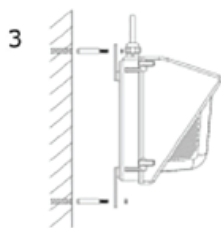

3 Push anchors into the holes. Match the mounting brackets to the anchors and attach the fixture to the wall with the screws provided.

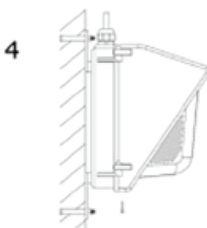

4 Connect the wires making sure there is good wire protection.



1 Take apart the PC cover and fixture housing

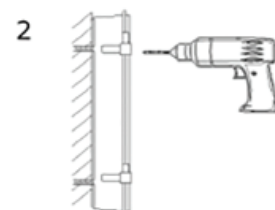

2 Hold the fixture firmly against the wall and drill 3 holes for the mounting brackets

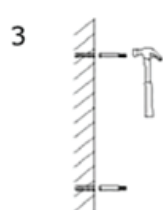

3 Push anchors into the holes. Line up the fixture to the wall with the holes and attach the fixture to the wall with the screws proved

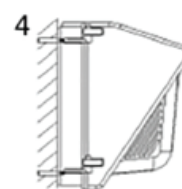

4 Put the PC cover and fixture housing back together.